

WE THE PLANET CAMPUS

PROGRAMM Corporate Architecture

The architectural study commissioned by New York-based organization #WeThePlanet (WTP) attempts to investigate new and forward-looking opportunities for people-friendly architecture in harmony with nature.

The #WeThePlanet Campus serves as a communicative platform to protect all life on land and under the sea while advancing the frontiers of design. The Campus offers facilities for convening international summits, workshops and educational programs which focus on transforming our world for a better future, and will be addressing topics such as human longevity and planetary flourishing, climate change, social justice and equal opportunities. The floating building complex is aimed at serving as an inspiring example for future life, living and working environments.

The basic idea behind this architectural concept is that in future all building projects should give back just as much substance to nature as they take from it. This would mean that as compensation for soil sealing, CO2 production and the use of energy and materials, new living environments would be created for flora and fauna (Neobiota). Consistently used, this could completely change our future cityscapes. What would then come into being would be new, innovative architectural structures, integrating 50% nature-oriented biotopes. The quality of life in the urban environment would be boosted enormously in every respect – a better air quality, more pleasant inner-city climates, cities would heat up less and our understanding of nature would be improved by experiencing it at first hand.

CURRENT WAY OF ARCHITECTURAL THINKING: 100% OF NEW BUILD SPACE IS RESERVED FOR HUMAN USAGE

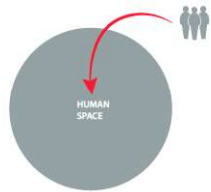

PROPOSED NEW ARCHITECTURAL APPROACH: NEWBUILT SPACE OFFERS HUMAN AND NATURE THE SAME SPACE

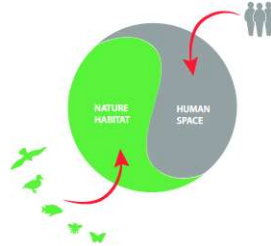

»In nature is the beauty,
the aesthetic and the heart of this project.«

LAURA MURAKA – CO-FOUNDER OF #WeThePlanet

THE CONCEPT PRINCIPLE BASED ON WE THE PLANET CAMPUS FOOTPRINT



45% HUMAN
45% NATURE
10% SHARED

DESCRIPTION OF ROOF MATERIAL & TECHNOLOGY

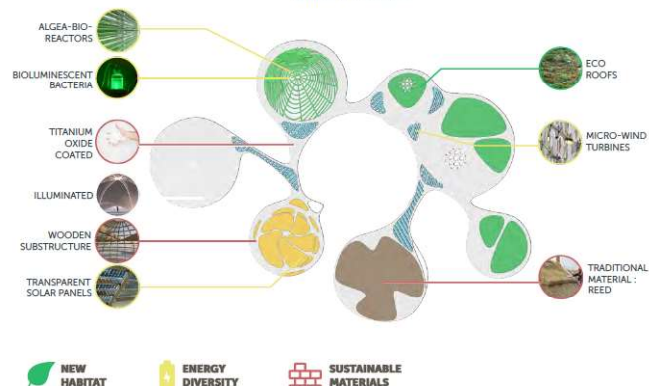

The WTP Campus' floating platform is a piece of real estate that is future-oriented, mobile and unaffected by rising sea levels. By creating a floating natural biotope, the WTP platform extends the tightly packed land area that is Manhattan by an extra piece of greenery.



The 50/50 concept foresees an architecture for the future that center on shared spaces for both people and nature. The basic idea behind this architectural concept is that in future all building projects should give back just as much substance to nature as they take from it.

WE THE PLANET CAMPUS



This party public platform not only represents an additional destination for New Yorkers for sports, leisure and communication, but also an attractive new honeypot for western Manhattan.

The beauty in nature & technology

The most salient aspect of this building idea is that of the floating marshland biotopes, making up 50% of the overall surface areas. However, it is not only here that living space will be created for flora and fauna, the meadow, the sand biotope, as the thatched and green roofs also produce living environments for a diversified, urban animal and plant world.

The building materials can be divided up into natural materials such as wood, clay or reeds and recycled materials such as bioplastics. The latest surface technologies for air cleansing will also be used, along with algae bioreactors, wind farms, photovoltaics and marine power plants under the platform for energy extraction.

The vision of the WTP Campus is to be completely self-sufficient in generating energy and drinking water. The sustainability measures are integrated in a fluid, organic design concept that cooperates with the forces of nature (wind, sun, water), thus making for a genuine, elegant naturalness.

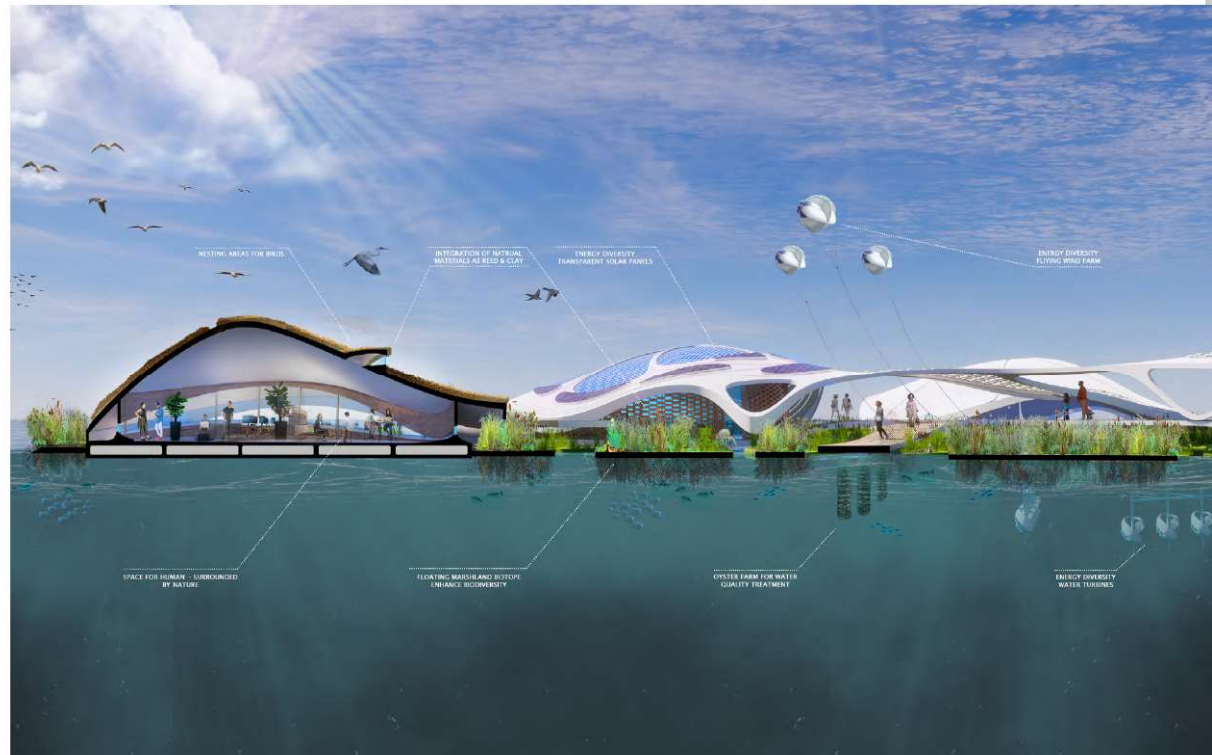
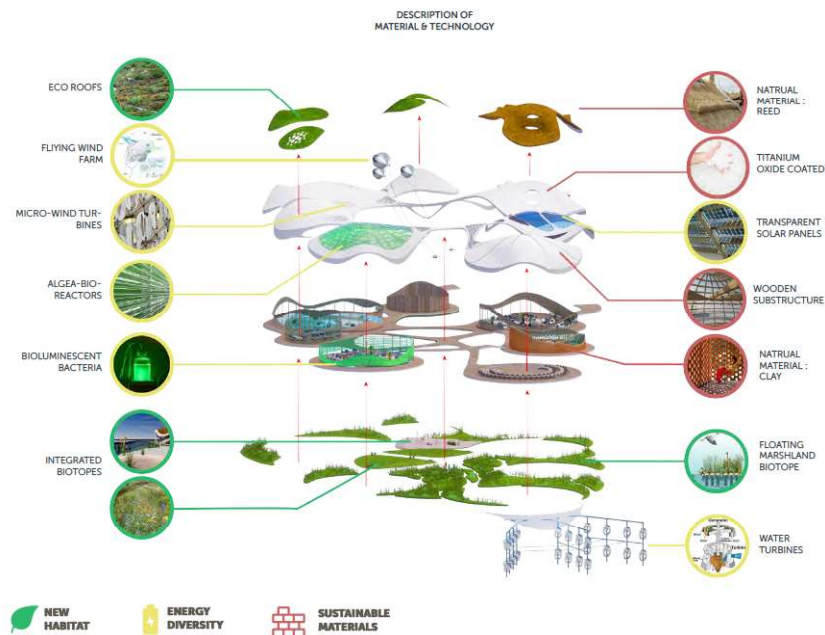

3d section - 3 layers (under water, water surface, air)



Floating Biotope